



JULIA LITTLE || LITTLEJULIA1@GMAIL.COM || 925-586-1149

ADDITIONAL PRODUCTION CREDITS





TITUS ANDRONICUS PRODUCTION RIGGER SPRING 2024

SCENIC DESIGNER: SEAN LILLIS
TECHNICAL DIRECTOR: CARLY GENOVESI
PHOTOS BY: SEAN LILLIS

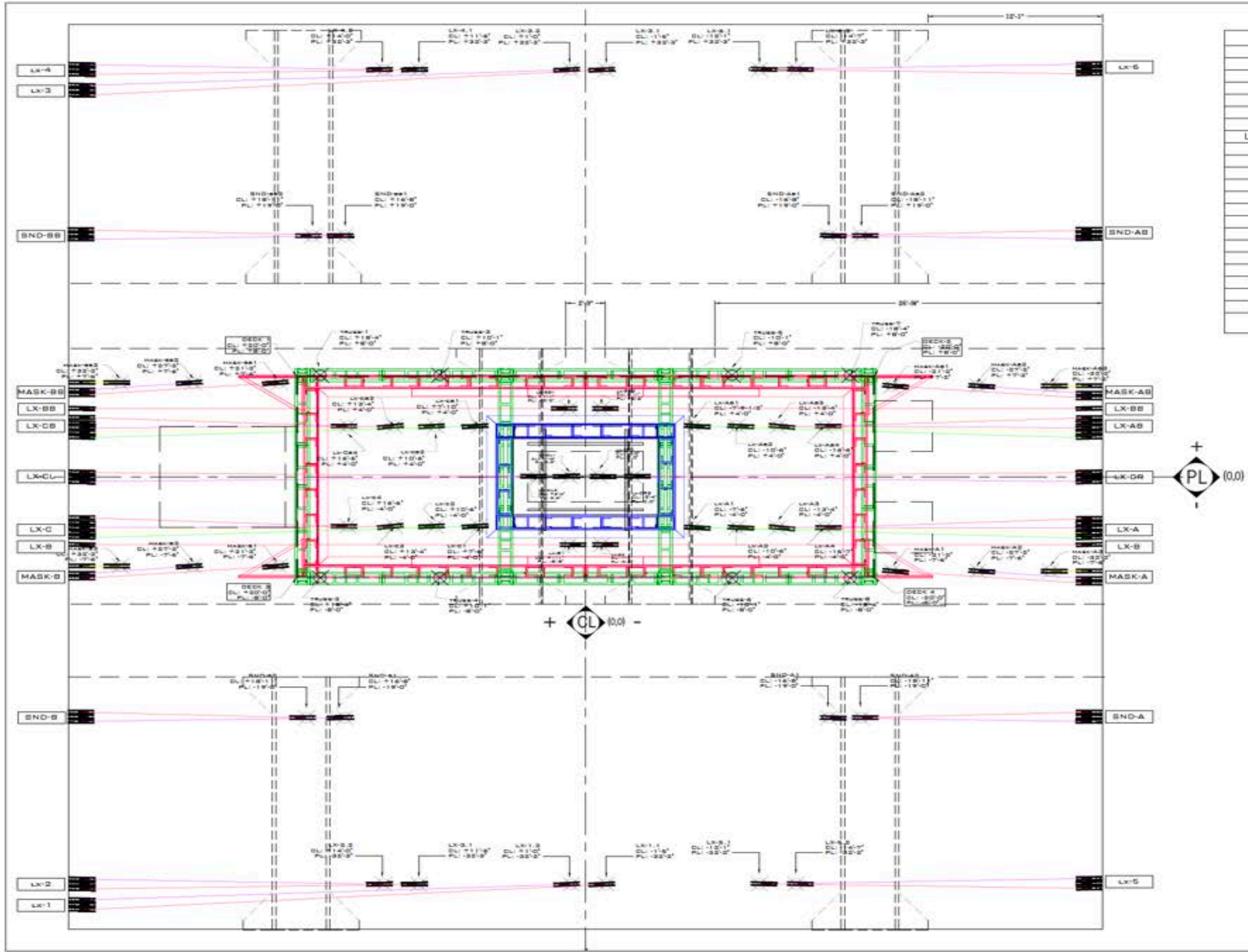

PIPE LENGTHS/WEIGHTS		
LABEL	LENGTH	WEIGHT
LX-A	9'-6 1/2"	300#
LX-AB	9'-6 1/2"	300#
LX-B	3'	30#
LX-BB	3'	30#
LX-C	9'-6 1/2"	300#
LX-CE	9'-6 1/2"	300#
LX-OR/CL	8'	200#
LX-1	4'	120#
LX-2	4'	120#
LX-3	4'	120#
LX-4	4'	120#
LX-5	4'	120#
LX-6	4'	120#
SND-A	3'	40#
SND-AB	3'	40#
SND-B	3'	40#
SND-BB	3'	40#
MASK-A	12'	
MASK-AB	12'	
MASK-B	12'	
MASK-BB	12'	
SUBTOTAL	ALL PIPES ARE	300#

TRIM HEIGHTS	
LABEL	HEIGHTS
LX-A	21'-0"
LX-AB	21'-0"
LX-B	21'-0"
LX-BB	21'-0"
LX-C	21'-0"
LX-CE	21'-0"
LX-OR/CL	20'-10"
LX-1	21'-0"
LX-2	21'-0"
LX-3	21'-0"
LX-4	21'-0"
LX-5	21'-0"
LX-6	21'-0"
SND-A	20'-0"
SND-AB	20'-0"
SND-B	20'-0"
SND-BB	20'-0"
MASK-A	20'-0"
MASK-AB	20'-0"
MASK-B	20'-0"
MASK-BB	20'-0"
TRUSS	24'-0"
CEILING	27'-0"
ATLUM	25'-0"

- NOTES:**
- CEILING = 12.4 LB/FT
 - ATLUM = 15.5 LB/FT
 - TRUSS = 9.4 LB/FT
 - LX-CL-R IS PLOWN OUT AND THEN SECURED TO THE ROLL-CAT
 - TECHNICAL ONLY WORKERS ABOUT THE PLOWN PIPE IN THE STUBBED
 - TRIM HEIGHTS ARE MEASURED FROM THE STAGE FLOOR
 - SQUARE POINTS ARE CEILING POINTS
 - NODES WITHOUT SHELVES CONNECTED TO THEM ARE TRUSS POINTS

TITUS ANDRONICUS

ABBOTT KAPLAN THEATRE

OVERALL RIGGING PLOT

THEATRE	30' x 41'
STAGE	30' x 41'
ATLUM	0

01

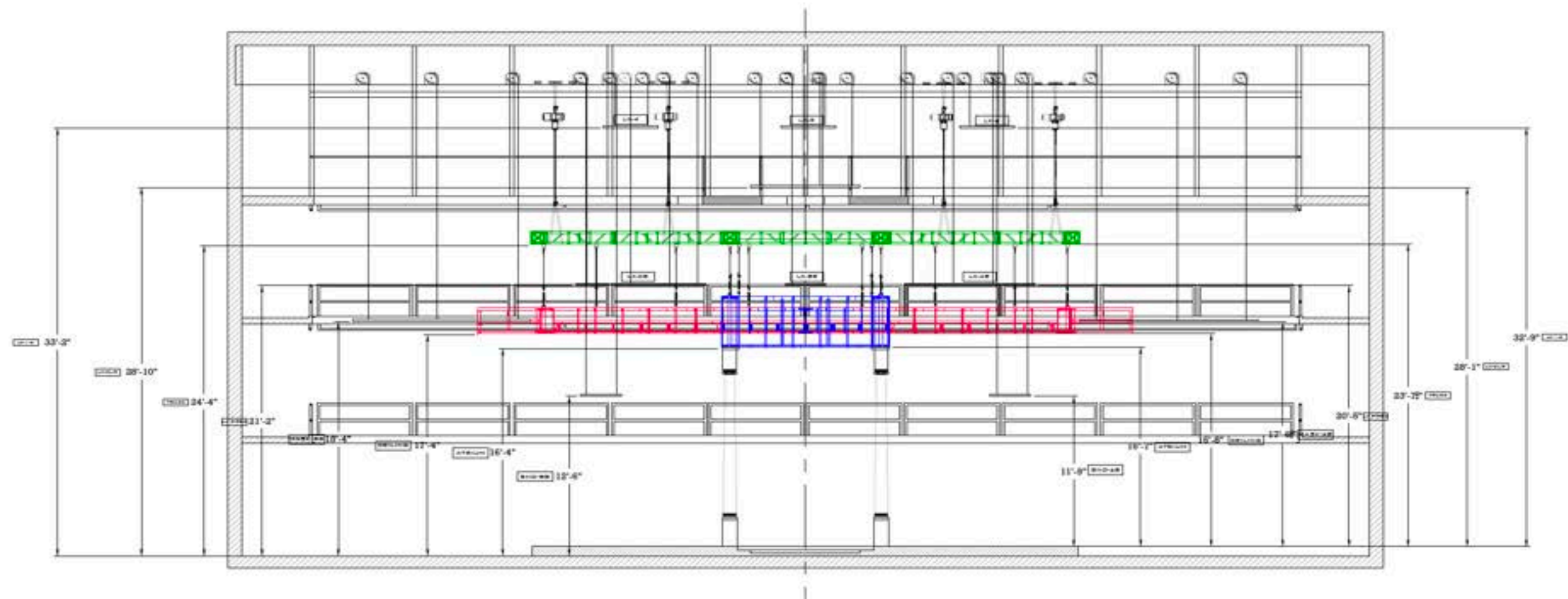

A EAST WALL CEILING SECTION
SCALE: 1/4" = 1'-0"

NOTES:
- TRIM HEIGHTS TO THE LEFT OF CL ARE MEASURED FROM THE STAGE FLOOR.
- TRIM HEIGHTS TO THE RIGHT OF CL ARE MEASURED FROM THE SHOW DECK.

TITUS ANDRONICUS		
ABBOTT KAPLAN THEATRE		
PURCHASE COLLEGE		
EAST WALL SECTION		
DATE: 1/1/24	SCALE: 1/4" = 1'-0"	SECTION: 1
DESIGNED BY: SEAN LILLES	WORKING DRAWING: CARLY GENOVESI	ISSUED BY: JULIA LITTLE

02A

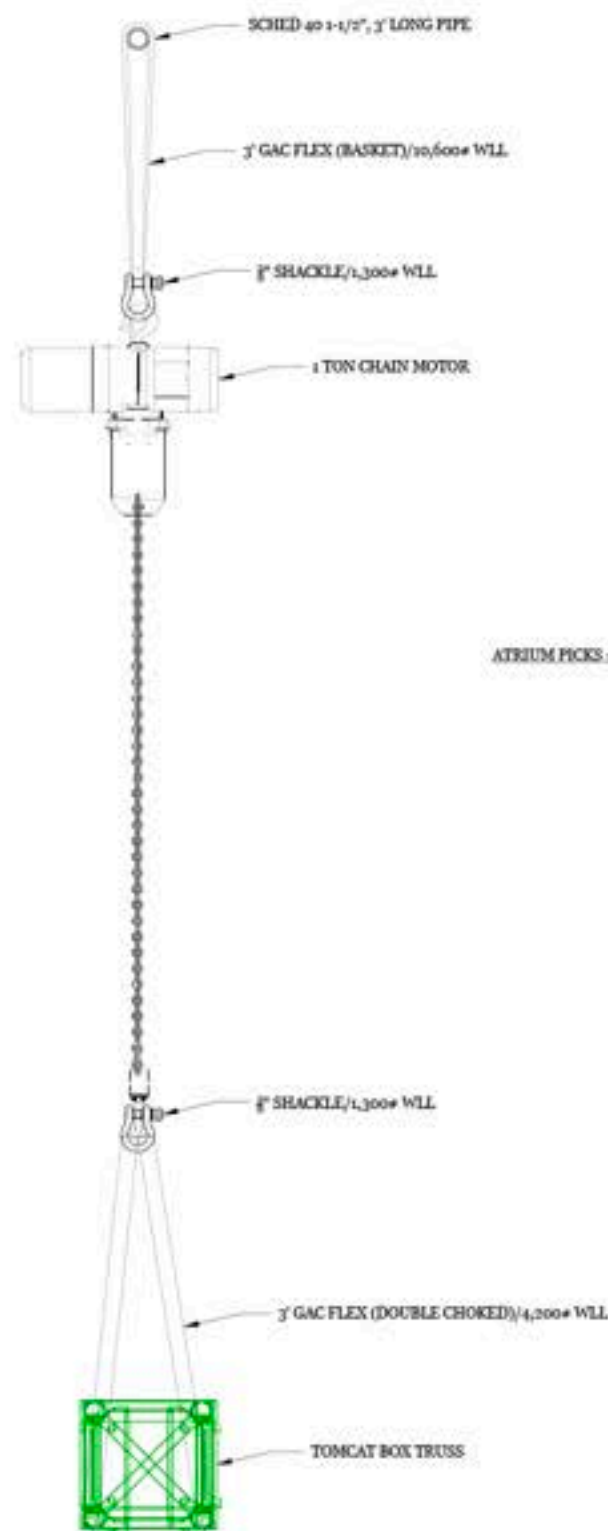

A1 GRID TO CHAIN MOTOR CONNECTIONS
SCALE: 1/4" = 1'-0"

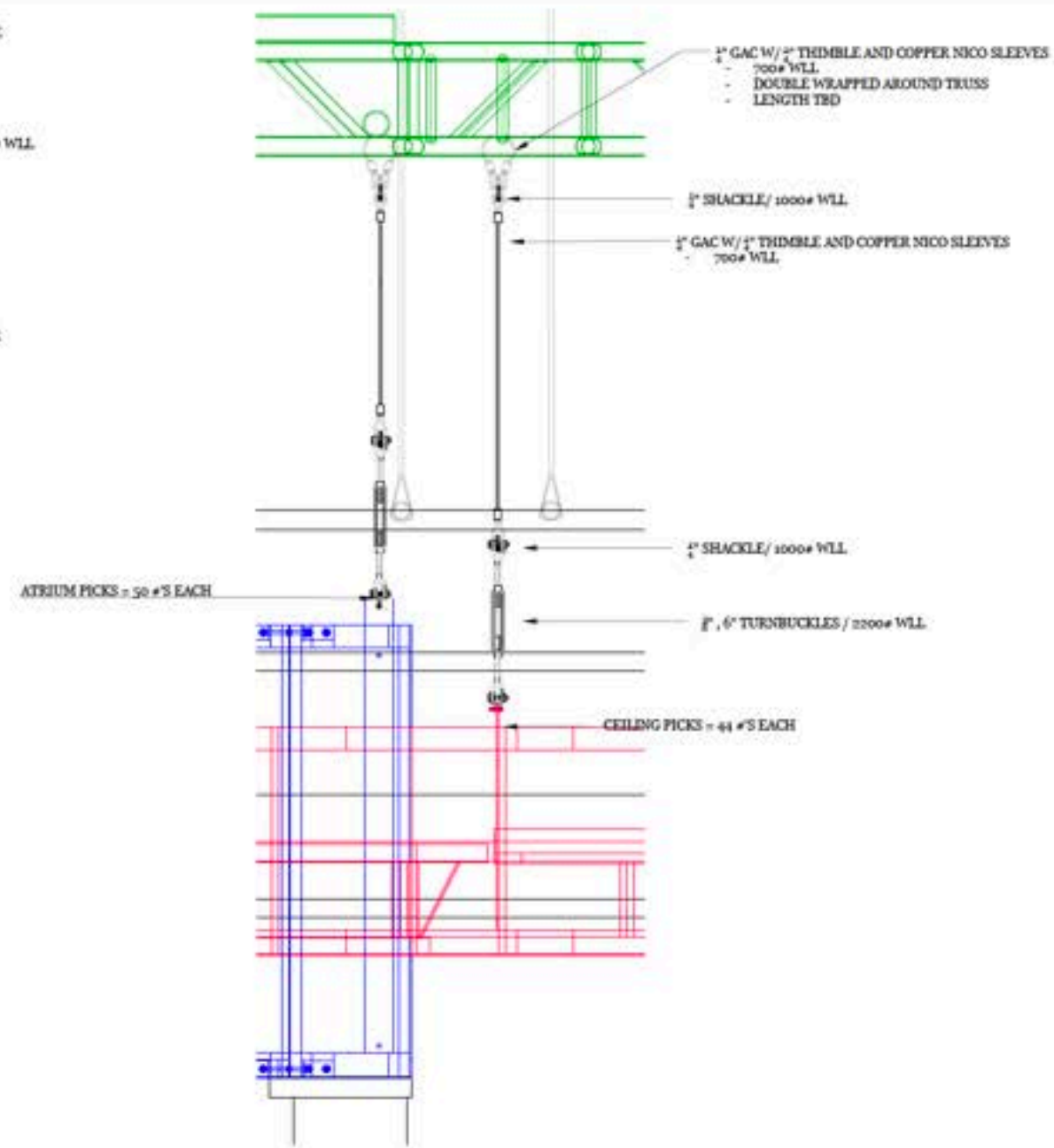

A2 TRUSS TO CEILING/ATRIUM PICKS
SCALE: 1/4" = 1'-0"



B1 CEILING PICKS
SCALE: 1" = 1'-0", PAGE 18



B2 ATRIUM PICKS
SCALE: 1" = 1'-0", PAGE 18

NOTES:
- MAKE PICKS WITH 1/2" GAC
- CUT GAC 1' LONGER THAN SHOWN
- MEASUREMENT TO ACCOUNT FOR
- TERMINATION METHOD
- TERMINATE ENDS WITH 1/2" THIMBLE
- AND A COPPER NICO PRESS SLEEVE
- SLEEVE GETS CRIMPED

NOTES:
- CEILING = 12.4 LB/FT
- ATRIUM = 65.3 LB/FT
- ALL 3" SPANSET'S AND 3/4" SHACKLES ARE COMING
- FROM PRG RENTAL PACKAGE

TITUS ANDRONICUS **ABBOTT KAPLAN THEATRE**

PURCHASE COLLAGE		
SECTION		
NORTH WALL SECTION - PICK/MOTOR DETAILS		
DRAWING SCALE	PAPER SIZE	
AS NOTED	24" x 36"	
PROJECT	REVISION	
4/20/24	1	
DESIGNED BY	TECHNICAL DIRECTOR	DRAWN BY
SEAN LILLIS	CARLY GENOVESE	SEAN LILLIS

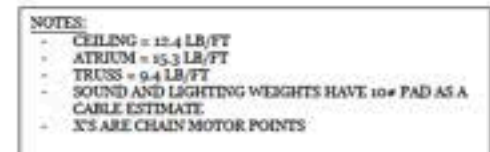

TITUS ANDRONICUS			
ABBOTT KAPLAN THEATRE			
PURCHASE COLLEGE			
TRUSS WEIGHTS AND MOTOR POINTS		SEATING CHART	
STAGING SPACE 11'6" x 12'	APPROX. 24' x 36'	03A	
PERIOD 1/18/24	ACTS 1		
TECHNICAL SEAN LILLIS	TECHNICAL DIRECTOR CARLY GENOVES		

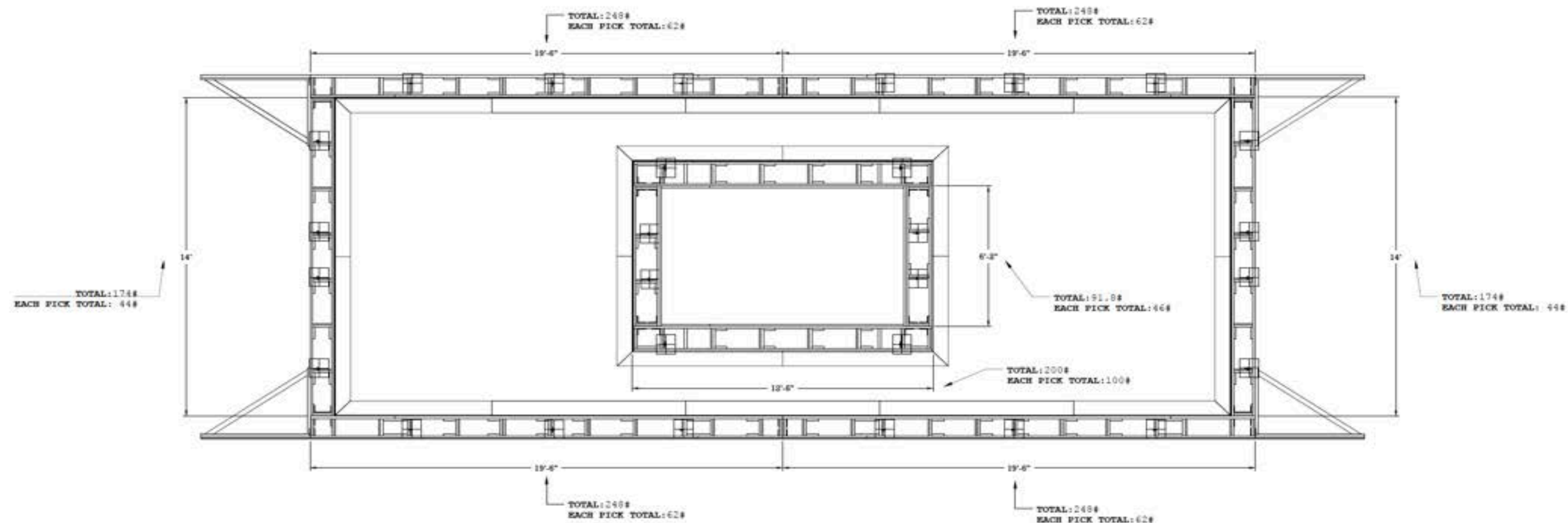

A CEILING PICK PLACEMENT - WEIGHTS PER SECTION
SCALE: 1/8" = 1'-0"

- NOTES:
- CEILING = 12.4 LB/FT
 - ATRIUM = 15.3 LB/FT
 - TRUSS = 9.4 LB/FT
 - X'S = PICK POINTS

TITUS ANDRONICUS
ABBOTT KAPLAN THEATRE

CEILING/ATRIUM PICK POINTS/WEIGHTS		DESIGNED BY
DESIGNED BY	DATE	24" x 36"
6/12/24	1/25/24	2
SEAN LILLIS	CARLY GENOVESI	JULIA LITTLE

03B

LOAD-IN
PROCESS





TITUS ANDRONICUS
PRODUCTION PHOTOS

PHOTOS BY: SEAN LILLIS



GOOD GOODS



ORESTES

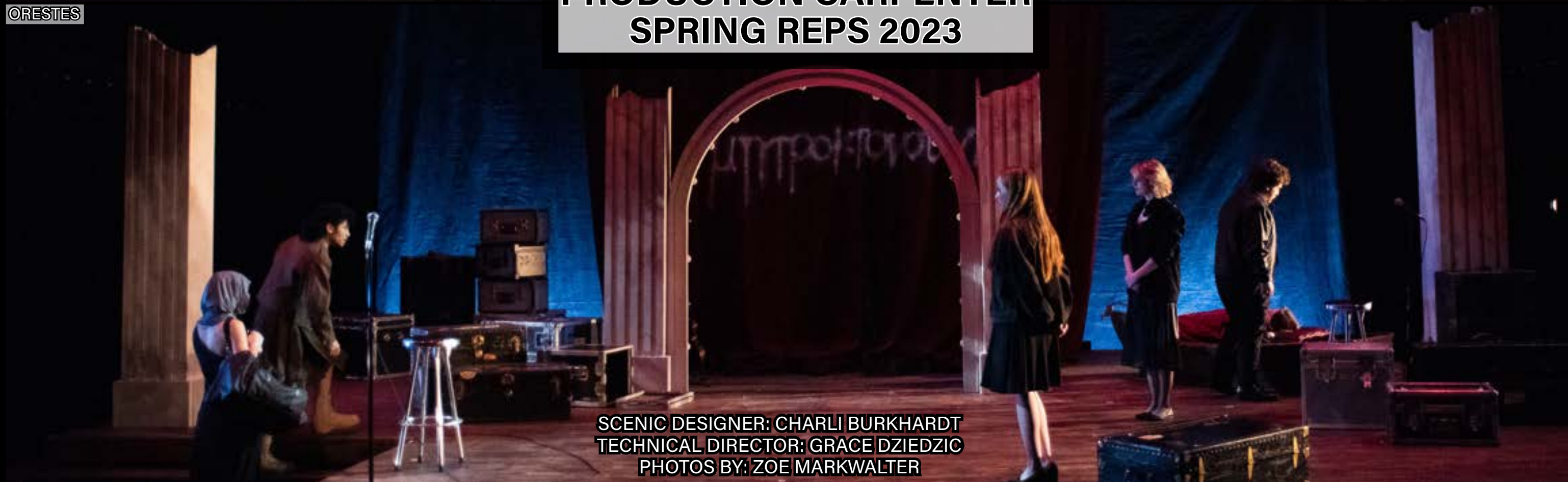

**GOOD GOODS/ORESTES
PRODUCTION CARPENTER
SPRING REPS 2023**

SCENIC DESIGNER: CHARLI BURKHARDT
TECHNICAL DIRECTOR: GRACE DZIEDZIC
PHOTOS BY: ZOE MARKWALTER

Spring Reps - Load In Calendar

Good Goods/Orestes

Technical Director: Grace Dziedic

Production Carpenter: Julia Little

Prepared by: Julia Little

Last Updated: 02-03-2023

February 2023

SUN	MON	TUES	WED	THURS	FRI	SAT
			1	2	3	4
					Rotations switch	
5	6	7	8	9	10	11
	Load-in prep:	Load-in Prep:		Load-in prep:	Load-in day 1:	
	3-6: Julia	3-6: Julia, Grace, Autumn		3-6: Grace and Julia	3-6: all hands on deck - Crew split between attic	
	- Organize hardware cart, Road boxes, and pull any additional tools we need	- Pulling pipe - Prepping the space, make sure theres ladders and genies and that all storage spaces are ready - start transporting deck		- Tape/chalk out floor - Organize everything for transport	- Begin legging deck platforms - grid install	
12	13	14	15	16	17	18
	Load in day 2:	Load in day 3:		Load in day 4:	Load in day 5:	
	3:30-6 - Crew split bewtween Attic	3-6 - Crew split between Attic		3:30-6 - Crew split between Attic	3-6 - Crew split between Attic	
	- Finish legging deck platforms - start Installing deck - grid install	3-3:15: TD Meeting - finish Installing deck - Install Posts and steps - Transport the rest of the scenery - grid install		- Begin Cyc and Drop install - Install remaining scenery	- Finish cyc and drop install - Install Kabuki drop - Finish installing any remaining scenery, stage should be set for Orestes	
19	20	21	22	23	24	25
	Load in day 7:	Load in day 8:		Load in day 9:		
	3:30-6 - Crew split between Attic and 12th Nt.	3-6 - Crew split between Attic and 12th Nt. - No Autumn		3:30-6 - Crew split between Attic and 12th Nt.		
	- Finish Kabuki install - seating risers/tech tables	- general cleaning and tidying - Make sure all changeover storage areas are clear		- finish up any remaining tasks - practice changeover for GG's tech the next day		
26	27	28				

Spring Reps - Transport List			
Good Goods/Orestes			
Technical Director: Grace Dziedic		Prepared by: Julia Little	Last Updated: 02-09-2023
	ITEM:	QUANTITY:	OTHER/NOTES:
Scene Shop			
<input type="checkbox"/>	BARNEY BOX		In A-trap
<input type="checkbox"/>	STAGE WEIGHTS	4	In A-trap
<input type="checkbox"/>	1/4" PADS	132	
<input type="checkbox"/>	LEGS	132	
<input type="checkbox"/>	2X4 BLOCKS	16	4" long
D-Trap			
<input type="checkbox"/>	JACKS	2	Anything less than 9', perferably the same, the smaller the footprint the better
<input type="checkbox"/>	SANDBAGS	2	on 3G
Paint Deck			
<input type="checkbox"/>	COLUMNS		
<input type="checkbox"/>	POSTS		
<input type="checkbox"/>	SMOKE STACKS		
<input type="checkbox"/>	STAIRS		
<input type="checkbox"/>	ARCHWAY		
<input type="checkbox"/>	FOAM ROCKS		
<input type="checkbox"/>	KABUKI PVC/FABRIC		

Spring Reps - Hardware/Pull List					
Good Goods/Orestes					
Technical Director: Grace Dziedic		Production Carpenter: Julia Little		Prepared by: Julia Little	Last Updated: 02-06-2023
SET PIECE:	HARDWARE:	SIZE:	LENGTH:	QUANTITY:	USE:
Deck					
<input type="checkbox"/>	Stove bolt sets	3/8"	3"	260	Deck legs
<input type="checkbox"/>	Hex bolt sets	3/8"	2-1/2"	86	Bolting seams
<input type="checkbox"/>	Creepers			2	
Steps					
<input type="checkbox"/>	Wood Screws	Standard	3"	Large deli cup	Attaching units together
Pillars					
<input type="checkbox"/>	Wood Screws	Standard	2-1/2"	Large deli cup	For US Pillar that gets removed
<input type="checkbox"/>	Blocks	2x4	6"	4	For US Pillar that gets removed
<input type="checkbox"/>	Shims	1/8"		8	For permanent pillars
Columns					
<input type="checkbox"/>	Wood Screws	Standard	2"	Small deli cup	Attaching jacks
<input type="checkbox"/>	Jacks		4-6'	2	Back of the US columns
<input type="checkbox"/>	Sandbags	25lbs?		2	Weight the jacks down
<input type="checkbox"/>	Bungee chords	Adjustable			Attach the DS columns to the posts
<input type="checkbox"/>	D-ring sets	Standard		8	For bungee chords to attach to
Archway					
<input type="checkbox"/>	Stove bolt sets	3/8"	3"	8	
Smoke stacks					
<input type="checkbox"/>	Hex bolt sets	3/8"	1-1/2"	2	Attaching sonotube to deck
<input type="checkbox"/>	Wood Screws	Standard	1-1/2"	10	Attaching sonotube to floor

Spring Reps - Changeover Run Sheet

Good Goods/Orestes

Technical Director: Grace Dziedic

Production Carpenter: Julia Little

Prepared by: Julia Little

Last Updated: 01-24-2023

Orestes -> Good Good's:

SCENIC ELEMENT:	ACTION:	LABOR NEEDS:	TOOL NEEDS:	NOTES:
DS Columns (2)	- Strike & store	1 person	none	- Attached to permanent posts w/bungee chords
Archway	- Unbolt from Columns on either side - Strike & store	2 people	- 9/16 socket wrench or 9/16 socket attached to an impact - Adj. wrench or 9/16 box wrench - 10' ladder	- Archway is all one unit so it needs to be carried carefully
Columns	- Strike & store store	2 people	none	- columns are supported by jacks
Kabuki Drop	- Strike & store curtain - Tie pipe up to the grid	2 people on the deck, 2 in the grid	- gloves, if needed, for the rope	
US Grafitti drop	- Strike & store	5 people	- gloves, if needed, for the rope	
Large props	- Strike & store	anyone who isn't busy at any given time	none	- guitar and amps
US Post	- Install	2 people	- 10' ladder?	- slots into the deck
Smoke stacks	- Install and attach to the deck/floor	2 people	- Screw guns with Robertson bit - 9/16 socket wrench or 9/16 socket attached to an impact - Adj. wrench or 9/16 box wrench - 10' ladder	
Largest props	- Place on spikes	4 people		- Bed, counter, coke cooler, grain box, large table, bench
Smaller props	- Place on spikes	2 people		- Crates, barrels, chairs, basin, etc...

Good Good's -> Orestes:

SCENIC ELEMENT:	ACTION:	LABOR NEEDS: (none of these counts include Julia)	TOOL NEEDS:	NOTES:
US Post	- Strike & store	2 people	- 10' ladder	
Smoke stacks	- Strike & store	2 people	- Screw guns with Robertson bits - 9/16 socket wrench or 9/16 socket attached to an impact - Adj. wrench or 9/16 box wrench - 10' ladder	
Largest props	- Strike & store	4 people	- Big strong muscles	Bed, counter, coke cooler, grain box, large table, bench
Smaller props	- Strike & store	2 people	- Less strong muscles	- Crates, barrels, chairs, basin, etc...
DS Columns (2)	- Install	1 person	none	- Attached to permanent posts w/bungee chords
Columns	- Install	2 people	none	- columns are supported by jacks that are weighted with sandbags
Archway	- Bolt to the columns on either side - Bring pipe into the deck from the grid	2 people	- 9/16 socket wrench or 9/16 socket attached to an impact - Adj. wrench or 9/16 box wrench - 10' ladder	- Archway is all one unit so it needs to be carried carefully
Kabuki Drop	- Replace Kubuki curtain - Fly to trim	2 people on the deck, 2 in the grid	- gloves, if needed, for the rope	
US Grafitti drop	- Bring pipe into the deck from the grid - Re-tie drop onto the pipe - Fly to trim	3 people	- gloves, if needed, for the rope	
Large props	- Place on spikes	Everyone at the end	none	- guitar and amps

Spring Reps - Changeover Calendar

Good Goods/Orestes

Technical Director: Grace Dziedic

Production Carpenter: Julia Little

Prepared by: Julia Little

Last Updated: 02-21-2023

February 2023

SUN	MON	TUES	WED	THURS	FRI	SAT
			1	2	3	4
					Rotations switch	
5	6	7	8	9	10	11
					Load-in day 1	
12	13	14	15	16	17	18
	Load in day 2	Load in day 3		Load in day 4	Load in day 5	
19	20	21	22	23	24	25
	Load in day 7	Load in day 8		Load in day 8	Tech Day #1 6:30pm-11pm Good Good's	Tech Day #2 11am-11pm Orestes
					- Changeover starts at 11pm	- Changeover starts at 11pm - Changeover Orestes to Good Goods even though next tech isn't till Monday
26	27	28				
	Tech Day #3 6:30pm-11pm Good Good's	Tech Day #4 3:30pm-11:00pm Orestes				
	- Changeover starts at 11pm	- Changeover starts at 11pm - Changeover Good Goods to Orestes even though next tech isn't till Thursday				

Spring Reps - Changeover Calendar

Good Goods/Orestes
Technical Director: Grace Dziedic Production Carpenter: Julia Little Prepared by: Julia Little Last Updated: 02-21-2023

March 2023						
SUN	MON	TUES	WED	THURS	FRI	SAT
			1	2	3	4
			Work Notes 7pm-10pm	Tech Day #5 6:30pm-11pm Good Good's	Tech Day #6 3:30pm-11pm Orestes	Tech Day #7 11am-11pm Good Good's
				- Changeover starts at 11pm	- Changeover starts at 11pm	- Changeover starts at 11pm - Changeover for Orestes even though next tech isn't till Monday
5	6	7	8	9	10	11
	Tech Day #8 3:30pm-11pm Orestes	Dress #1 7pm-11pm Good Good's	Dress #2 3:30pm-11pm Orestes	Dress #3 7pm-11pm Good Good's	Dress #4 3:30pm-11pm Orestes	Opening Good Good's/Orestes
	- Changeover starts at 11pm	- Changeover starts at 11pm	- Changeover starts at 11pm	- Changeover starts at 11pm	- No changeover	- Changeover from Orestes to GG's before actors are called - Start time TBD - Curtain @ 1:30pm: GG's - Changeover in-between - times dependant on show run times - Curtain @ 7:30pm: Orestes
12	13	14	15	16	17	18
Show Day #2 Orestes/Good Good's	Show Day #3 Good Good's	Show Day #4 Orestes	Show Day #5 Good Good's	Show Day #6 Orestes		
- Curtain @ 1:30pm: Orestes - Changeover in-between - times dependant on show run times - Curtain @ 7:30pm: GG's - No need to changeover	- Curtain @ 7:30pm - Changeover dependant on show run times	- Curtain @ 7:30pm - Changeover dependant on show run times	- Closing - Curtain @ 7:30pm - Changeover dependant on show run times	- Closing - Curtain @ 7:30pm - No changeover		
19	20	21	22	23	24	25
26	27	28	29	30	31	

Spring Reps - Load in report #4

Orestes/Good Goods

~

TD: Grace Dziedzic

PC: Julia Little

PF: Autumn Brathwaite

Thursday, February 16th

Technical (3:00-6:00)-

Accomplished today:

- Moved the deck to its correct spikes
- Finished attaching together and padding the deck
 - We just have one seam to fix that we noticed right at the end of call
- Re-installed posts and stairs
- Installed the cyc
- Prepped the pipe for the drop

Goals for next call (Friday, February 16th, 3-6pm):

- Transport finished scenery and kabuki pipes from paint deck
- Start seating risers
- Finish putting baton clamps on and drop all the ropes for the drop
- Get the kabuki pipe hung

Lighting (3:00-10:00)-

Accomplished today:

- Hung booms
- Rough focus of the grid

Goals for next call:

- Cable booms
- Continue focus
- Possibly set deck units

Sound (3:00-10:00)-

Accomplished today:

- Set up a1 station
- Finished hanging all their speakers
- Cabeled all speakers in the air
- Had fun

Goals for next call:

- Get the sub installed
- Cable the speaker booms
- Have more fun

Other notes:

Spring Reps - Load in report #7

Orestes/Good Goods

~

TD: Grace Dziedzic

PC: Julia Little

PF: Autumn Brathwaite

Tuesday, February 21

Technical (3:00-6:00)-

Accomplished today:

- Installed smoke stacks
- Struck Orestes set
- Got Kabuki drop to drop
- Cut fascia for the front of the deck and brought it to paint deck
- Brought quick change booth flats to the space

Goals for next call (Thursday, February 23, 3-6pm):

- Install quick change booth
- Work on Kabuki pipe
- Cut out plugs for the holes in the decks
- Put masking in its place
- Re-inforce smoke stacks if we have the time

Lighting (3:00-10:00)-

Accomplished today:

- Installed power for tech tables
- Finished focus

Goals for next call:

- cueing

Sound (3:00-10:00)-

Accomplished today:

- Ran all coms (minus booth coms)
- Got dressing room and god mic working
- Focused and leveled side speakers

Goals for next call:

- Finish focusing speakers
- Troubleshoot unity

Other notes:

- Thank you sound for setting up the tech tables

**BUILD/LOAD-IN
PROCESS**









**ORPHEUS DESCENDING
LEAD TECHNICAL DESIGNER
FALL 2022**



**SCENIC DESIGNER: KYLER STERNER
TECHNICAL DIRECTOR: GRACE DZIEDZIC
PHOTOS BY: ZOE MARKWALTER**

Orpheus Descending

TD: Grace Dziedzic
LTD: Julia Little

Drafting Report
Week of Sept 19th

Accomplished:

- Brought candy store flat and center stair handrail drawings to shop
- Made progress on platform and center stair unit drawings

Goals for tomorrow and next week:

- Finish all drawings that are in progress right now

Notes/Questions:

- Center step drawing was approved but we are making some small revisions regarding the stringer and different angles we're working with. I might make a plate that's just the pieces we're sure of and get that to the shop if they find themselves needing something to do tomorrow
- Thank you to Chris Bohne, Chris Grainer, and Autumn for helping us this week!

Drafting Progress Checklist:

Note: This is not ALL of the units, just what we plan to work on for the rest of the month, this list will grow and change as the show progresses :)

Plate #	Drawing	Working	Sent to John	Approved	In the shop!
1	Candy Store Wall	✓	✓	✓	✓
2	Center Stairs	✓	✓	✓	
2.5	Center Stair handrail	✓	✓	✓	✓
	SL/SR Stairs				
	Escape Stairs				
	Center Platform	✓			
	SL/SR Platform	✓			
	Main Wall top and bottom				

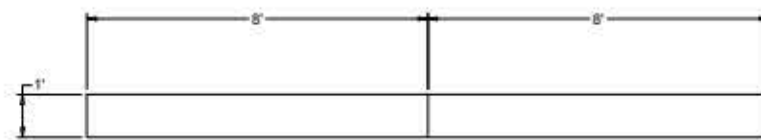

A1 STRINGERS - OUTSIDE LAYER
MAKE 2 FROM 3/4 PLYWOOD

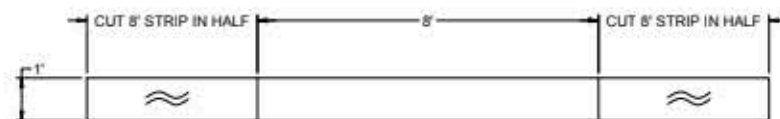

A2 STRINGERS - INSIDE LAYER
MAKE 2 FROM 3/4 PLYWOOD, REVERSE AND REPEAT

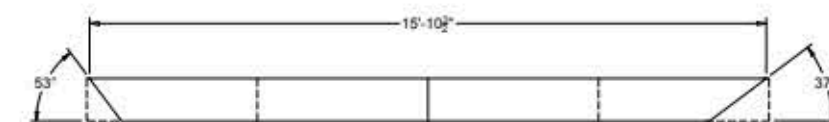

A3 STRINGERS - ANGLES AND LAMINATING
LAMINATE WITH GLUE AND STAPLES, CUT ANGLES, THEN BOLT ANGLE IRON

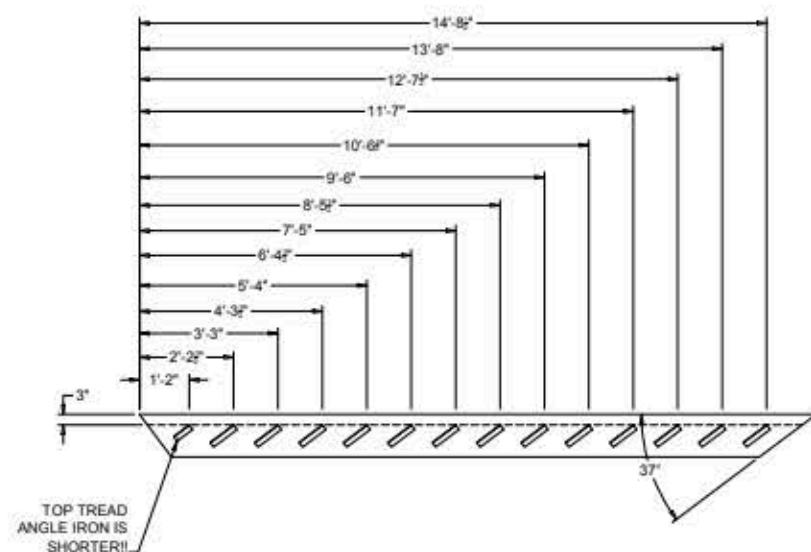

A4 STRINGERS - ANGLE IRON PLACEMENT
BOLT ANGLE IRON TO STRINGERS. USE 3/8 X 2 1/2\"/>

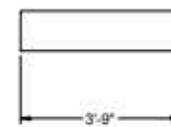

B1 TREADS
CUT 14 FROM 2X12



B2 STIFFENERS
CUT 14 FROM 2X4

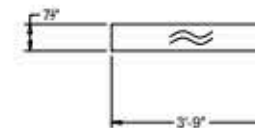

B3 RISERS
CUT 13 FROM 1/4 PLYWOOD

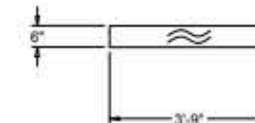

B4 BOTTOM RISER
CUT 1 FROM 1/4 PLYWOOD

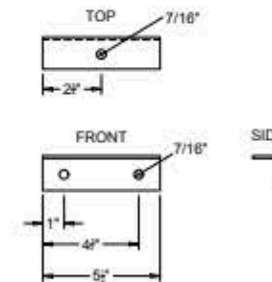

B5 TOP TREAD ANGLE IRON
CUT 2 FROM 1.5\"/>

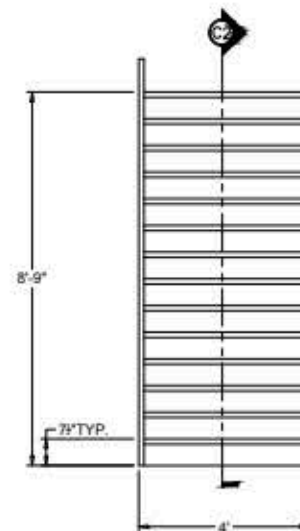

C1 FRONT ELEVATION

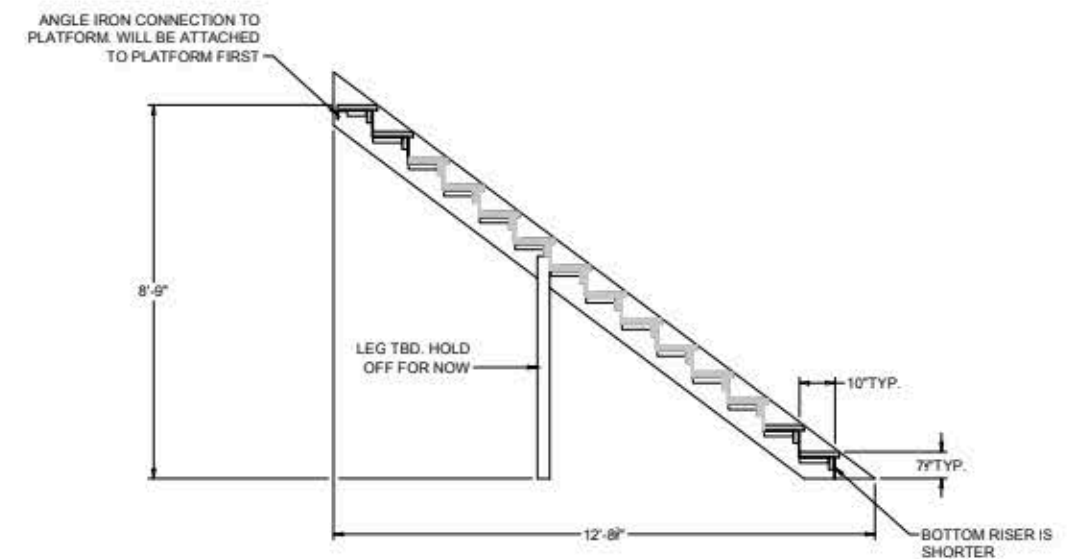

C2 STAIR SECTION VIEW

NOTES:
BEFORE ASSEMBLING STAIRCASE, DISCUSS TRANSPORT METHODS

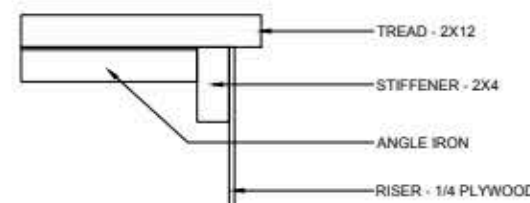

C3 ASSEMBLED TREAD - LARGE SCALE DETAIL
SCALE = 3\"/>

- BOLT TREAD TO ANGLE IRON USING 1/2\"/>

ORPHEUS DESCENDING			
PEPSI-CO THEATRE			
TECHNICAL DRAWING			
SUBJECT			DRAWING NUMBER
CS STEP UNIT, TREADS AND STRINGERS			02
DRAWING SCALE		PAPER SIZE	
1/4" = 1'-0"		24X36	
PUBLISHED		REVISED	
SEPTEMBER 30, 2022			
TECHNICAL DIRECTOR	TECHNICAL ADVISOR	LTD	DRAWN BY
GRACE DZIEDZIC	JOHN ECKERT	JULIA LITTLE	GRACE DZIEDZIC

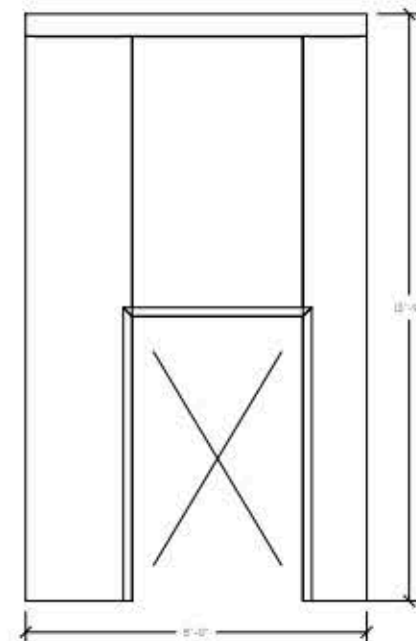

PLATFORM WALL - FRONT ELEVATION 8'-0" x 13'-0"

- ATTACH TO PLATFORM IN THEATRE
- SOFT COVER APPLIED IN THEATRE
- ATTACH DOOR CASING LAST

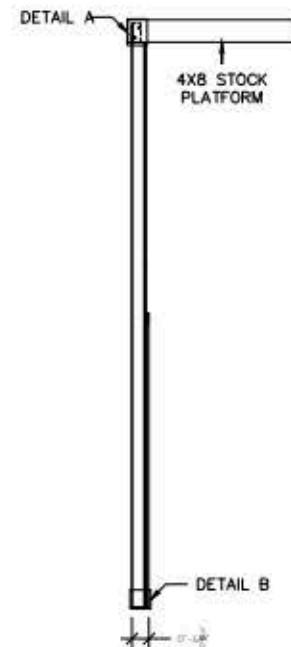

PLATFORM WALL - SIDE 2'-0" x 13'-0"

Notes

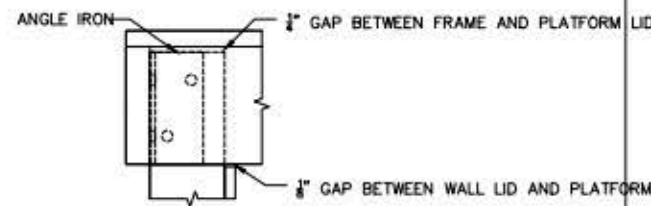

DETAIL A 0'-3" x 1'-0"
• ATTACH ANGLE IRON TO FRAME AND PLATFORM WITH 3/8" - STOVE BOLTS

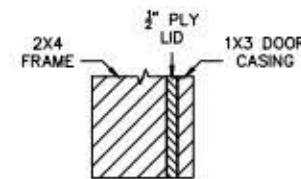

DETAIL B 3'-1" x 1'-0"



DOOR CASING - TOP 4'-0" x 1'-0"

- MAKE ONE (1) FROM 1X3
- ATTACH IN THEATRE AFTER SOFT COVERING



DOOR CASING - SIDE 2'-0" x 1'-0"

- MAKE TWO (2) FROM 1X3
- ATTACH IN THEATRE AFTER SOFT COVERING

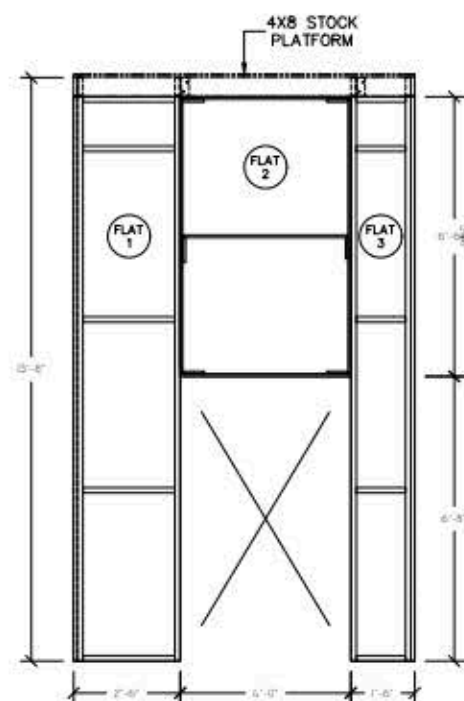

PLATFORM WALL - FRAMING 8'-0" x 13'-0"

- BOLT FLATS TOGETHER WITH 3/8" - 3" HEX BOLTS
- ATTACH FRAME TO PLATFORM IN SPACE

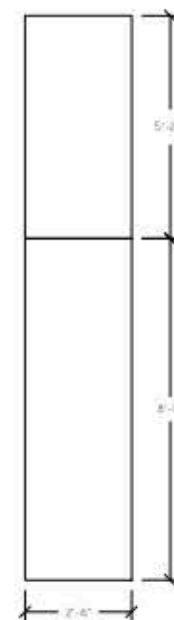

FLAT 1 - 2'-0" x 6'-0"

- MAKE ONE (1) FROM 1/2" PLY

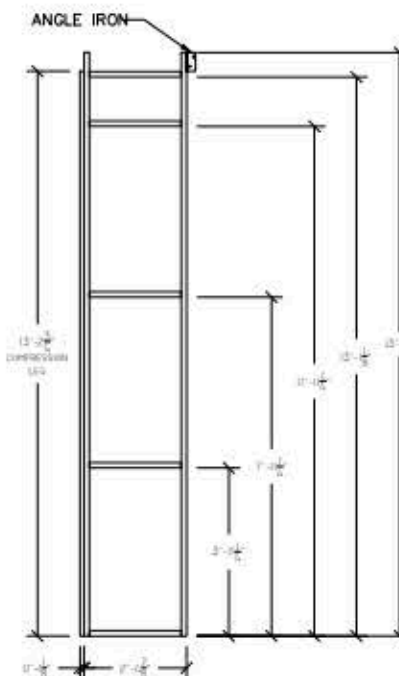

FLAT 1 - FRAMING 2'-0" x 6'-0"

- MAKE FROM 2X4, GLUE AND SCREW
- ALL JOINTS
- NO NAILING BLOCKS
- MAKE COMPRESSION LEGS FROM 5/4X6 RIPPED TO 3.5"

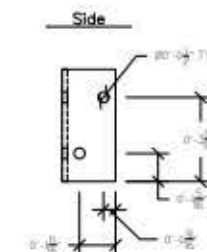

ANGLE IRON 2'-0" x 1'-0"

- MAKE TWO (2) FROM 2.5 X 2.5 X 1/4 ANGLE IRON
- ATTACH TO FRAMING WITH 3/8" - 2" STOVE BOLTS

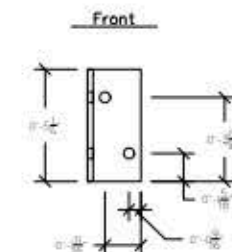

ANGLE IRON 3'-1" x 1'-0"

ORPHEUS DESCENDING			
PEPSI-CO THEATRE			
TECHNICAL DRAWING			
SUBJECT		DRAWING NUMBER	
4X8 PLATFORM WALL		7.5	
DRAWING SCALE		PAPER SIZE	
0' - 0" = 1'-0"		24X36	
PUBLISHED		REVISED	
OCTOBER 9, 2022			
TECHNICAL DIRECTOR	TECHNICAL ADVISOR	LTD	DRAWN BY
GRACE DZIEDZIC	JOHN ECKERT	JULIA LITTLE	CHRIS BOHNE

A1 4X4 PLATFORM LID
CUT HOLES IN ALREADY EXISTING LID

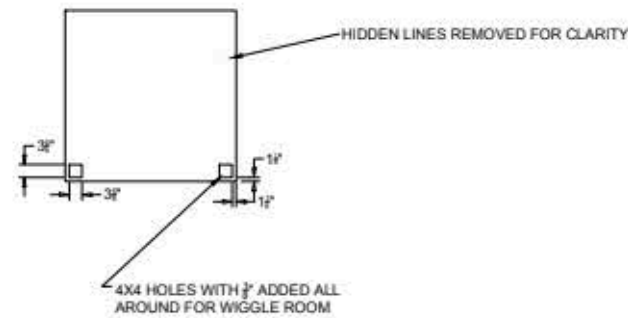

A3 4X4 PLATFORM TOP VIEW
REMOVE NAILING BLOCKS TO MAKE LEG PLACEMENT POSSIBLE

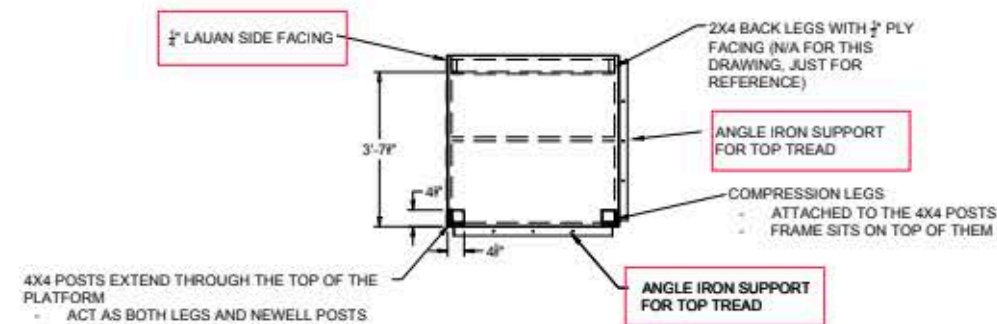

B1 4X4 PLATFORM COMPRESSION LEGS
CUT 2 OF EACH LENGTH FROM 5/4X8

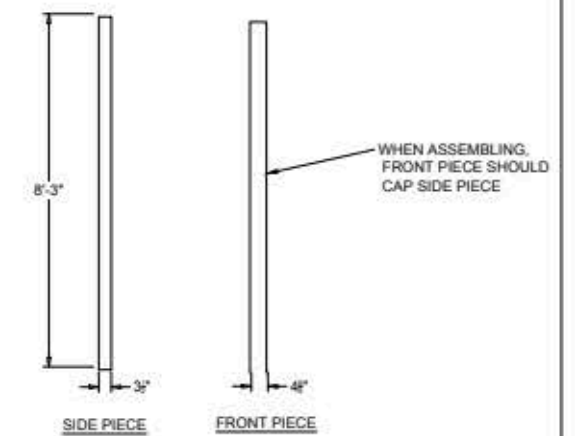

A2 4X4 PLATFORM SR SIDE FASCIA
CUT FROM 1/4" LAUAN

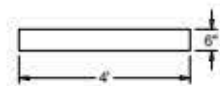

A4 TOP TREAD ANGLE IRON SUPPORT
1-1/2" = 1'-0", MAKE 2 FROM 2.5"X2.5"X1/4" ANGLE IRON

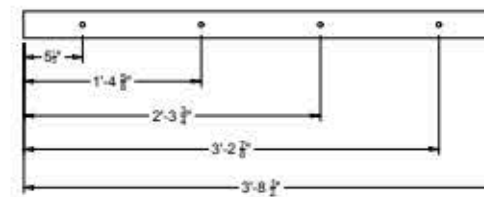

THIS VIEW GETS ATTACHED TO PLATFORM EDGE

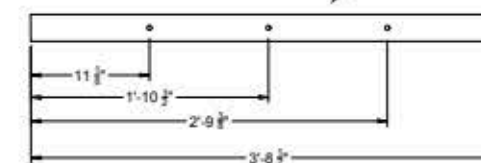

THIS VIEW GETS ATTACHED TO TOP TREAD

B2 4X4 PLATFORM COMPRESSION LEGS ASSEMBLY
3"=1'-0", MAKE 1 THEN REVERSE AND REPEAT

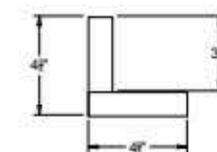

B3 4X4 PLATFORM FRONT LEGS/NEWELL POSTS
CUT 2 FROM 4X4 STICK LUMBER

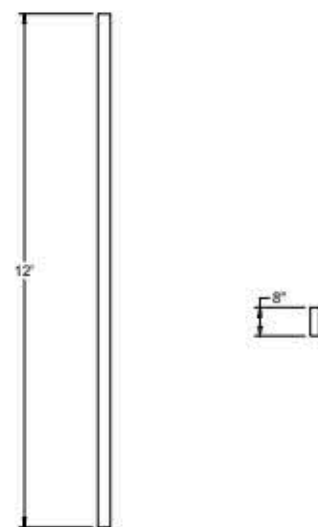

B4 LEG CROSS BRACING
CUT 4 FROM 1X3 STICK LUMBER



C1 4X4 PLATFORM FRONT LEGS/POST ASSEMBLY, FRONT VIEW

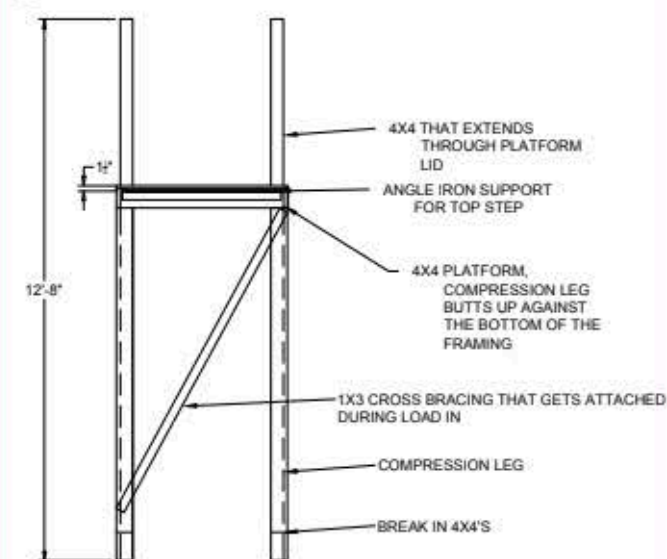

- NOTES**
- CUT HOLES IN PLATFORM LID USING A $\frac{1}{2}$ " DRILL BIT TO MAKE AN INITIAL HOLE IN THE CENTER OF THE SQUARE. A JIGSAW TO MAKE A ROUGH CUT, AND THEN USE A ROUTER TO GET IT ALL THE WAY TO THE EDGES
 - 2X4 LEGS WITH $\frac{1}{2}$ " FACING GETS INSTALLED IN THE SPACE
 - TECH TOGETHER PLATFORM WITH 4X4 LEGS IN THE SHOP TO MAKE SURE THEY FIT
 - THEY'LL BE TRANSPORTED SEPARATELY FOR LOAD IN
 - BOLT 4X4 LEGS TO THE PLATFORM USING 5/8" BOLTS, 1/2" FLAT WASHERS, AND 1/2" LOCK NUTS
 - MAKE HOLES WITH $\frac{1}{2}$ " DRILL BIT
 - 5/8" FOR COMPRESSION LEGS NEEDS TO BE RIPPED DOWN
 - GLUE AND STAPLE COMPRESSION LEGS TOGETHER USING WOOD GLUE AND 2" NARROW CROWN STAPLES THEN GLUE AND USE 3" SCREWS TO ATTACH THEM TO THE 4X4 POSTS
 - GLUE AND BRAD SIDE FASCIA ONTO THE PLATFORM WITH WOOD GLUE AND 1" BRADS
 - CROSS BRACING WILL GET ATTACHED TO THE LEGS DURING LOAD IN
 - USE A $\frac{1}{2}$ " DRILL BIT TO DRILL HOLES IN THE ANGLE IRON
 - BOLT TO THE PLATFORM USING 1/2" 2" LONG STOVE BOLTS, 1/2" FLAT WASHERS, AND 1/2" LOCK NUTS
 - ANGLE IRON TOP TREAD SUPPORT GETS ATTACHED TO THE FRONT OF THE 4X4 AND ON THE SL SIDE OF THE PLATFORM

ORPHEUS DESCENDING			
PEPSI-CO THEATRE			
TECHNICAL DRAWING			
SUBJECT		DRAWING NUMBER	
4X4 STOCK PLATFORM ALTERATIONS		05.1	
DRAWING SCALE	PAPER SIZE		
$\frac{1}{2}$ " = 1'-0"	24X36		
DATE	DATE		
OCTOBER 4, 2022	OCTOBER 13, 2022		
TECHNICAL DIRECTOR	TECHNICAL ADVISOR	LTD	DRAWN BY
GRACE DZIEDZIC	JOHN ECKERT	JULIA LITTLE	JULIA LITTLE

OVERALL ORTHOGRAPHICS

A3 4X8 PLATFORM TOP VIEW
MAY NEED TO REMOVE NAILING BLOCKS TO PLACE LEGS

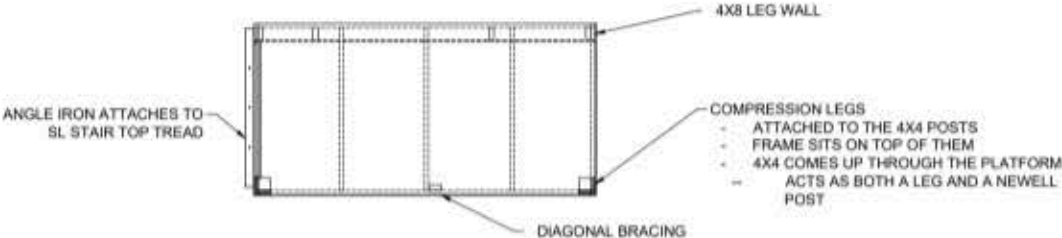

A1 4X8 PLATFORM SIDE VIEW FOR ASSEMBLY

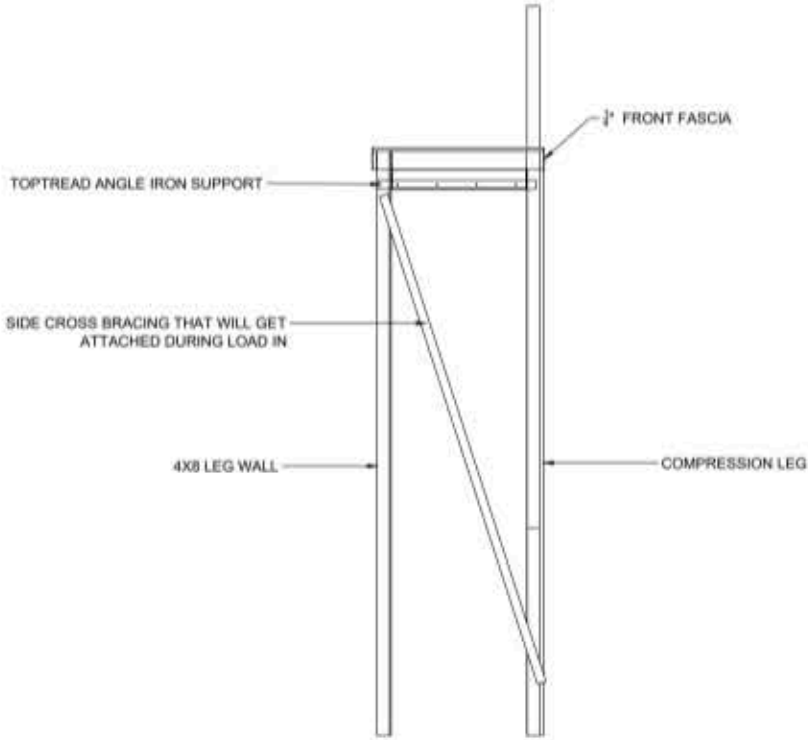

A2 4X8 PLATFORM FRONT VIEW FOR ASSEMBLY

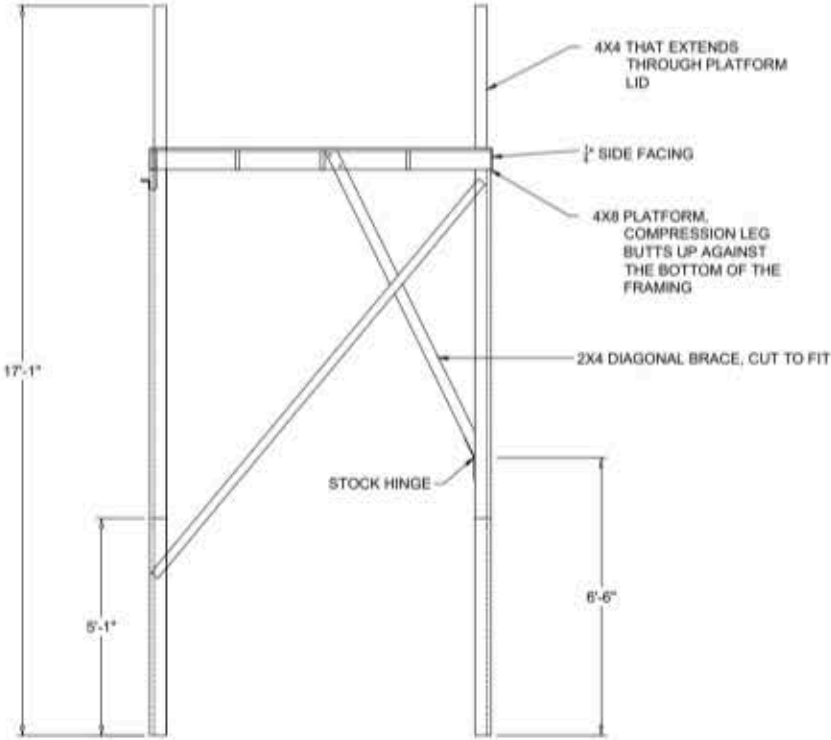

- NOTES:
- BOLT ANGLE IRON TO THE PLATFORM AND TREAD USING 1/2" 3" STOVE BOLTS, 1/2" LOCK NUTS, AND 1/2" FLAT WASHERS
 - DRILL HOLES USING A 5/8" DRILL BIT
 - USE THE SAME HARDWARE FOR 1/2" TO 5/4X8 CONNECTION
 - BOLT DIAGONAL BRACING TO THE PLATFORM FRAMING USING 1/2" 3" STOVE BOLTS, 1/2" LOCK NUTS, AND 1/2" FLAT WASHERS
 - ONE 4X4 DOESN'T EXPAND THE WHOLE LENGTH
 - COMPRESSION LEG WILL HOLD THE 2 4X4'S TOGETHER
 - ATTACH 1/2" SIDE FACING WITH WOOD GLUE AND 1" BRADS
 - MAKE SURE THAT 1/2" SCAB BOLT HOLES DONT INTERFERE WITH ANGLE IRON BOLTS

ORPHEUS DESCENDING

PEPSI-CO THEATRE

TECHNICAL DRAWING

4X8 STOCK PLATFORM ALTERATIONS, ASSEMBLY

DRAWING SCALE: 1/2" = 1'-0"

PUBLISHED: OCTOBER 14, 2022

TECHNICAL DIRECTOR: GRACE DZIEDZIC

TECHNICAL ADVISOR: JOHN ECKERT

C.T.D.: JULIA LITTLE

DRAWN BY: JULIA LITTLE

DRAWING NUMBER

05.3

A1 SL STEP UNIT WALL ELEVATION

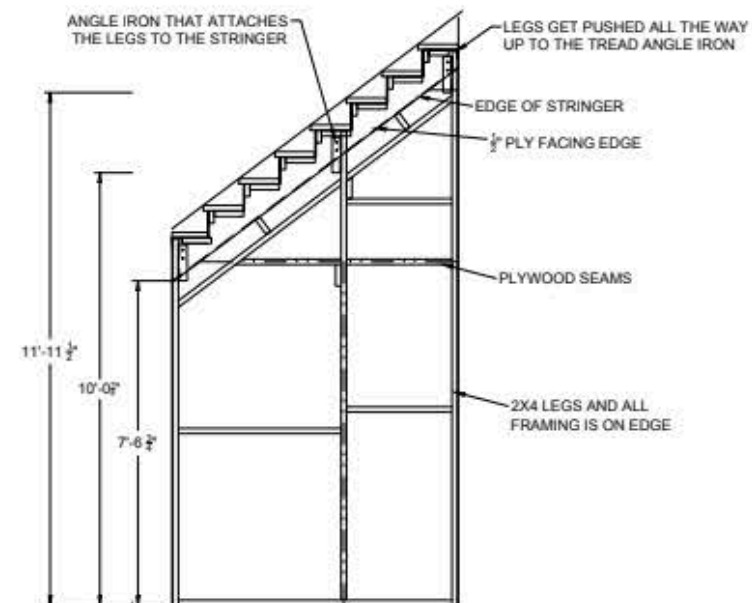

DIMENSIONS ARE FOR ANGLE IRON PLACEMENT

A2 SL STAIR WALL FRAMING
MAKE 1

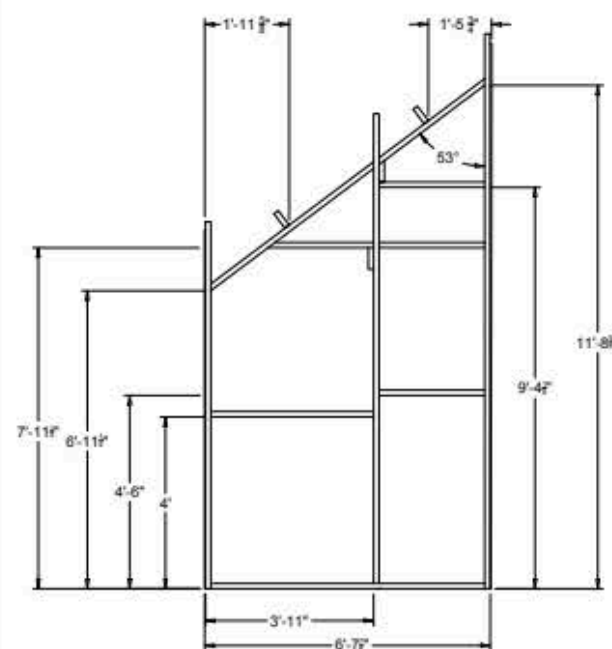

B1 SL STAIR WALL FACING
CUT 1 OF EACH TYPE FROM 1/2\" PLY

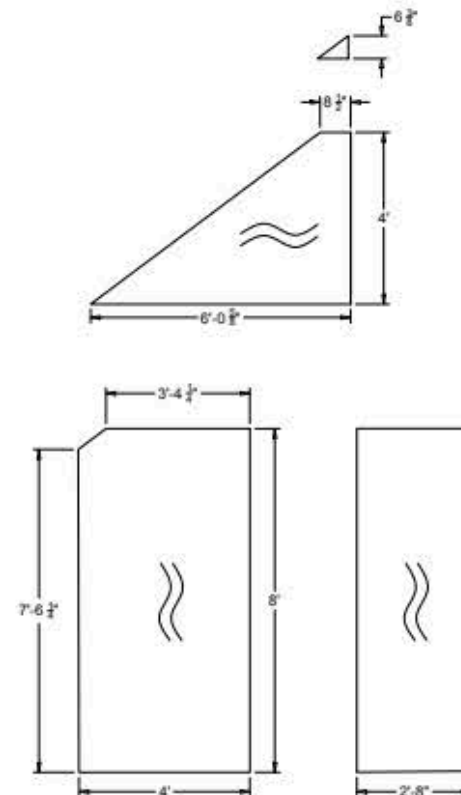

C1 SL STEP UNIT LEGS
CUT 1 OF EACH LENGTH FROM 2X4

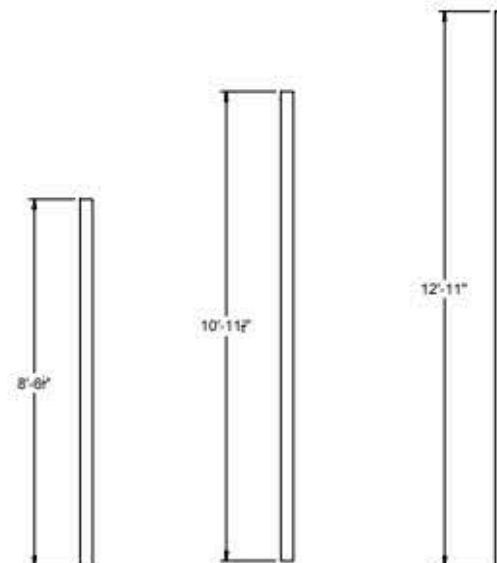

B2 SL STAIR WALL NAILING STRIPS
CUT 1 OF EACH LENGTH FROM 1/4\" LAMIN

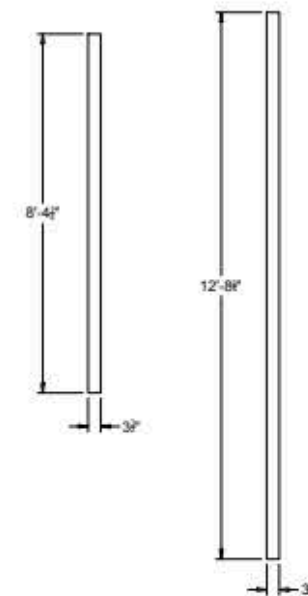

B3 SL STAIR WALL NAILING BLOCKS
CUT 1 OF EACH TYPE FROM 2X4

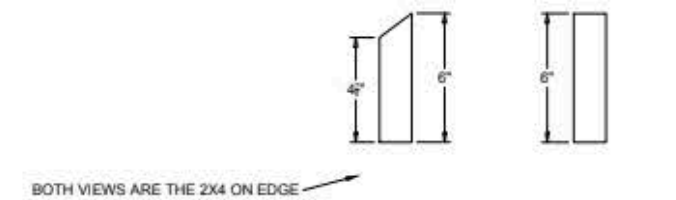

B4 SL STAIR WALL DIAGONAL FRAMING MEMBERS
CUT 2 FROM 2X4 LUMBER

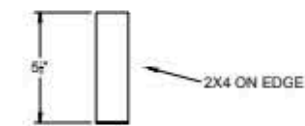

D2 SL STAIR 2X4 LEG SUPPORTS
3\"x 1'-0\", MAKE 3 TOTAL MAKE 1. REVERSE AND REPEAT FOR THE OTHER 2

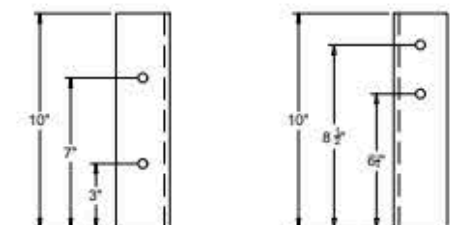

STRINGER SIDE

2X4 LEG SIDE

- NOTES:
- ALL DIMENSION LINES EXTEND TO THE BOTTOM OF WHAT ITS BEING DIMENSIONED TO
 - GLUE AND SCREW ALL FRAMING WITH WOOD GLUE AND 3\" SCREWS
 - ATTACH 1/2\" NAILING STRIPS WITH GLUE AND NARROW CROWN STAPLES
 - ALL FRAMING IS ON EDGE
 - USE A 1/8\" DRILL BIT TO DRILL INTO ANGLE IRON
 - ATTACH 1/2\" PLY FACING WITH GLUE AND NARROW CROWN STAPLES
 - USE 2 5X2 5X2\" ANGLE IRON FOR THE LEG SUPPORTS

ORPHEUS DESCENDING			
PEPSI-CO THEATRE			
TECHNICAL DRAWING			
SUBJECT			
SL STAIR UNIT WALL		DRAWING NUMBER	
DRAWING SCALE	PAPER SIZE	08	
AS NOTED	24X36		
PUBLISHED	REVISED		
OCTOBER 10, 2022			
TECHNICAL DIRECTOR	TECHNICAL ADVISOR	LTD	DRAWN BY
GRACE DZIEDZIC	JOHN ECKERT	JULIA LITTLE	JULIA LITTLE

**LOAD-IN
PROCESS**







SWEAT
SCENIC DESIGNER: LEANA PILI
TECHNICAL DIRECTOR: MADI MORRISSEY



EVERYBODY
SCENIC DESIGNER: SAMANTHA TUTASI
TECHNICAL DIRECTOR: MADI MORRISSEY



LEAD SHOP CARPENTER ASSIGNMENTS
FALL 2021-SPRING 2022

LIFE IS A DREAM
SCENIC DESIGNER: SAMANTHA TUTASI
TECHNICAL DIRECTOR: MADI MORRISSEY



WAITING FOR GODOT
SCENIC DESIGNER: PAULINE WALSH
TECHNICAL DIRECTOR: BECCA LAMBERT



Fall Festivals- Scene Shop Report

TD: Madi Morrissey PC: Grace Dziedzic LTD: Israel Hart LSC: Julia Little

10 SEPTEMBER 2021

ACCOMPLISHED TODAY

- Pulled 1x4 and 1x3 hogs troughs from D-trap, disassembled them and are using their lumber
- Finished 2x8 masking wall, brought to paint deck
- Finished 1 of the 4x10 masking walls and brought it to paint deck
 - Just need to lid it and then it'll be done
- Finished bracing C, brought to paint deck
- Cut all the pieces for bracing A and began assembling them
- All lumber is cut for the bar unit

GOALS FOR NEXT CALL (Monday, September 13)

- Finish the remaining 4x10 masking wall and bring it to paint deck
- Finish all of the bracing units and bring to paint deck
- Begin assembling the bar unit

MATERIAL TRACKER

Material	Ammt pulled	Shop or show stock	Piece/Project	Show
¼" Luan	1 sheet	Shop	Masking wall, T2	Sweat
Hogs trough 1x3	9 ½ sticks	Shop	Masking walls, T1&2	Sweat
Hogs trough 1x4	16 sticks	Shop	Bracing pieces	Sweat



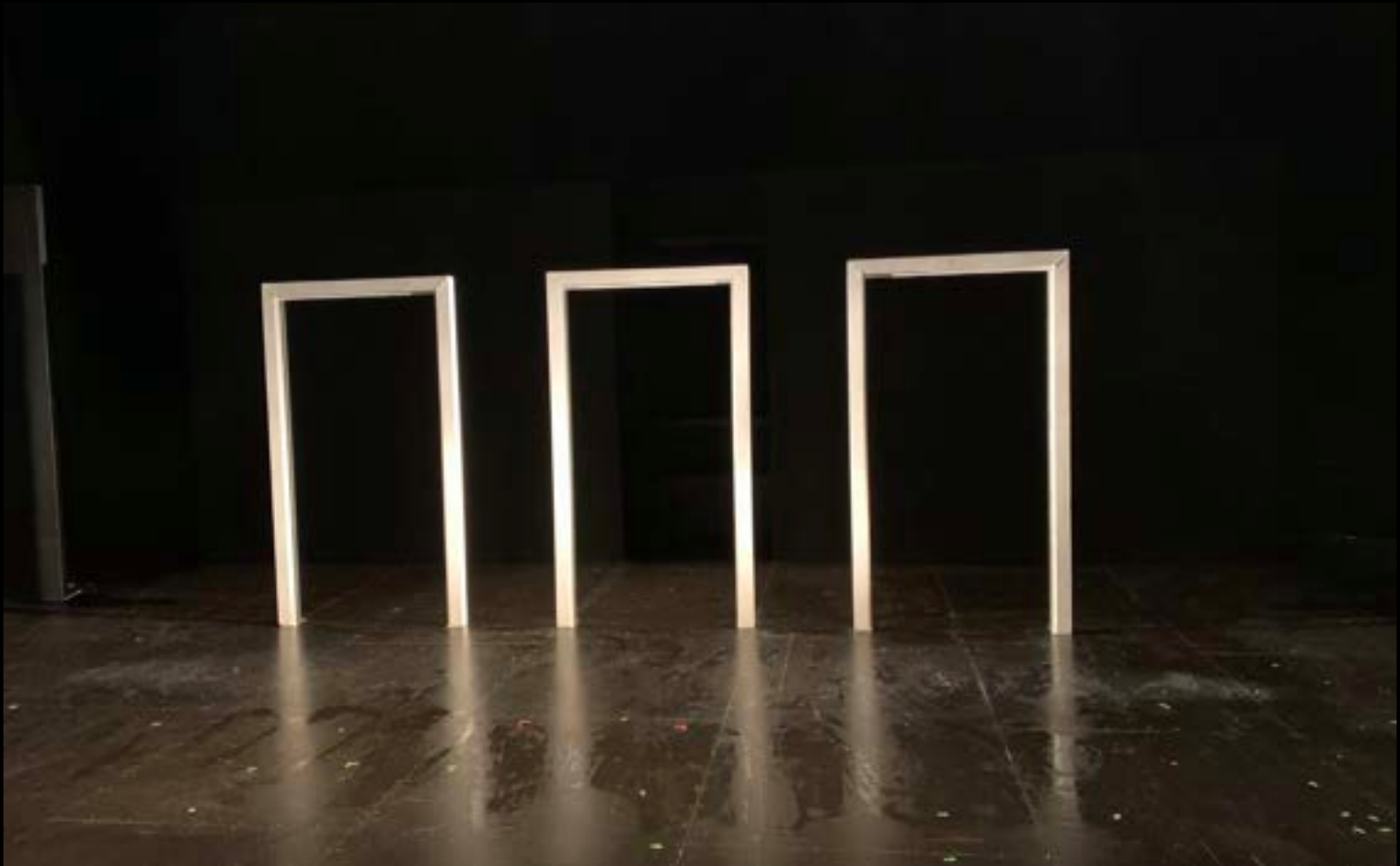

PHOTOS BY: ZOE MARKWALTER

Life is a Dream - Scene Shop Report #6

TD: Madi Morrissey PC: Meredith Young LTD: Grace Dziedzic LSC: Julia Little

22 OCTOBER 2021

ACCOMPLISHED TODAY:

- Finished the second raked platform (A)
- Built the frame for both raked platform B's
- Began assembling the wood caverns
- Finished cutting the metal for the metal caverns
- Cleaned paint deck for their saturday class
- Madi and I met to make a build schedule for next week

GOALS FOR NEXT CALL (MONDAY, OCTOBER 25TH, 3:30-10:00):

- Lay out and label first level maso on paint deck
- Complete the raked platforms
- Start drilling holes in metal and begin welding
- Finish wood caverns
- Bring speed rail to paint deck

MATERIAL TRACKER:

Material	Ammnt pulled	Shop or show stock	Purpose/Project
1/4" Maso	6 sheets	Show	Deck lids
5/4" x 6"	6 sticks	Show	Raked Platforms and wood caverns
2 1/2" x 2 1/2" Box tube	4 sticks	Show	Metal caverns





PHOTOS BY: ZOE MARKWALTER

Waiting For Godot

TD: Becca Lambert PC: Kaitlyn DiDomenico LTD: Connor McGlone
PF: Autumn Brathwaite LSC: Julia Little

ACCOMPLISHED TODAY

- Cut out and finished moss flooring pieces: 2, 4, 8, 18, 19, 20,
 - Started 15
- Both pieces of the tree are cut (scroll down to see an image!) they just need to be sanded down and assembled on the base

GOALS FOR NEXT CALL (Friday, February 18th, 3:00pm-6:00pm)

- Finish moss flooring pieces and the muslin rectangles
- Finish and assemble tree

LUMBER TRACKER -

Material	Ammnt pulled	Shop or show stock	Purpose/Project
¾" ply	2 sheets	Show	Tree

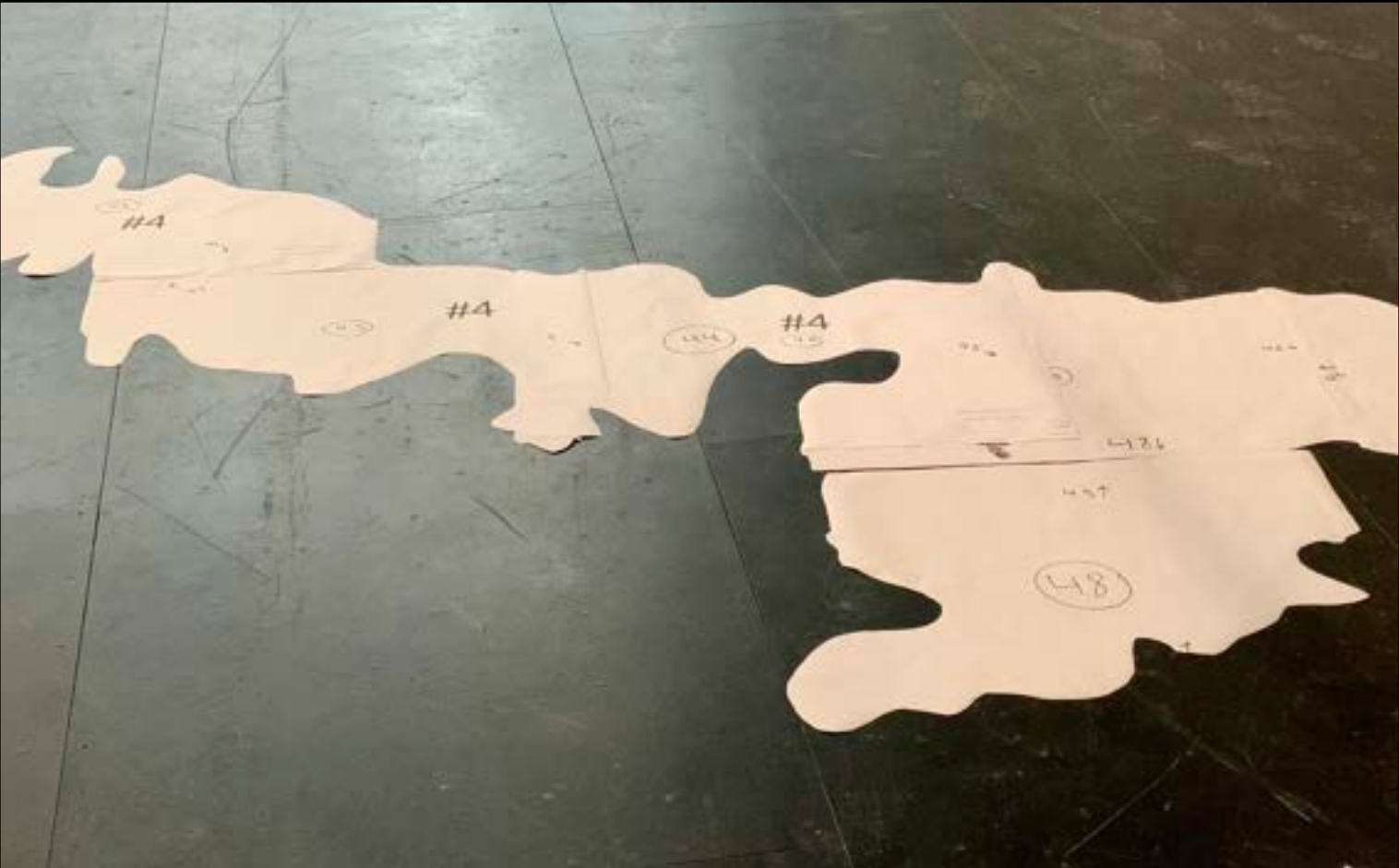



PHOTOS BY: ZOE MARKWALTER

