

32 → 5 226'-0"
 31 → 5 202'-7/2"
 30 → 5 189'-0"
 29 → 5 170'-0"
 28 → 5 154'-6"
 27 → 5 135'-0"
 26 → 5 121'-0 1/8"
 25 → 5 109'-0 1/8"
 24 → 5 97'-2 3/8"
 23 → 5 85'-5 1/8"
 22 → 5 73'-0"
 21 → 5 60'-0"
 20 → 5 48'-0"

TOP OF STAGE TOWER CORNICE
 EL. 405'-0"

SCORION
 4'-0 1/2" x 2"

LOADING BRIDGE
 9'-11 1/2" x 2"

REAR STAGE CORNICE
 EL. 371'-0"
 FLY GALLERY
 2'-0 1/2" x 3"

STAGE
 EL. 333'-2"
 CEILING
 EL. 304'-0 1/8"

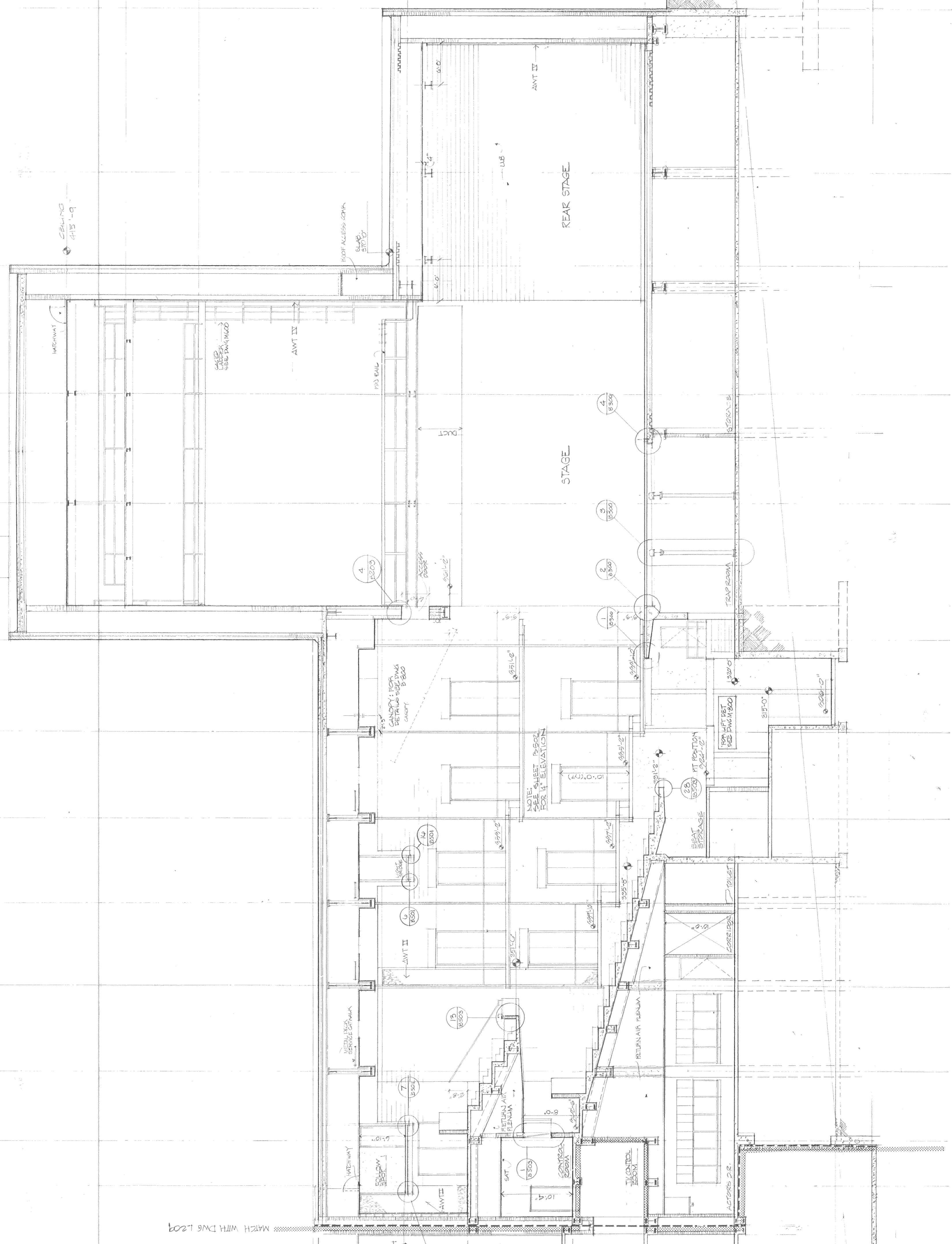

MATCH WITH DWG L209

TOP OF CORNICE
 EL. 391'-0"
 CLIMB
 5'-0" x 1'-0" x 1'-0"
 EL. 371'-0"
 BALCONY
 EL. 358'-0"
 PLATE
 EL. 345'-0"
 CONCRETE
 EL. 344'-0"
 TV CONTROL RM.
 EL. 332'-0 1/8"
 LAMP
 EL. 330'-0"
 DR. BEAMS
 EL. 325'-0"
 GRANITE
 EL. 305'-0"
 MESH
 EL. 300'-0"

NOTE: FOR FOUNDATIONS SEE STRUCTURAL DWGS.



STATE UNIVERSITY OF NEW YORK COLLEGE AT PURCHASE
 STATE UNIVERSITY CONSTRUCTION FUND
 PROJECT NUMBER 2520
PERFORMING ARTS CENTER
 EDWARD LARIBEE BURNES FAJA ARCHITECT
 PETER G. ROLLAND ARCHITECT
 WESLEY AND FOGWORTH CONSULTING ENGINEERS
 SEGER AND DUTTON CONSULTING ENGINEERS
 BOY, BEANER AND NEUMAN ARCHITECTS

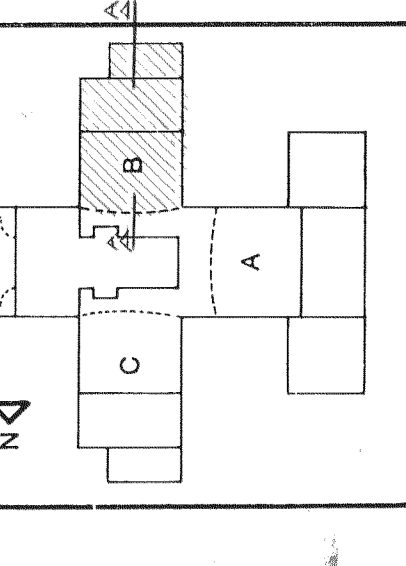

BUILDING SECTIONS
PAC B206
 SCALE 1/8" = 1'-0"
 DATE 10 MAY 1972
 DRAWN

SECTION A-A
 TAKEN AT ④ LOOKING EAST

CONFORMED DWG.