

32 → 5 226'-0"  
 31 → 5 202'-7 1/2"  
 30 → 5 189'-0"  
 29 → 5 170'-0"  
 28 → 5 154'-6"  
 27 → 5 135'-0"  
 26 → 5 121'-0 1/8"  
 25 → 5 109'-0 1/8"  
 24 → 5 97'-2 3/8"  
 23 → 5 85'-5 1/8"  
 22 → 5 73'-0"  
 21 → 5 60'-0"  
 20 → 5 48'-0"

TOP OF STAGE TOWER CORNICE  
 EL. 405'-0"

SCORION  
 4'-0" x 2'-0"

LOADING BRIDGE  
 9'-11 1/2" x 1'-0"

REAR STAGE CORNICE  
 EL. 371'-0"  
 FLY GALLERY  
 2'-0" x 1'-0"

STAGE  
 EL. 333'-2"  
 CEILING  
 EL. 304'-0 1/8"

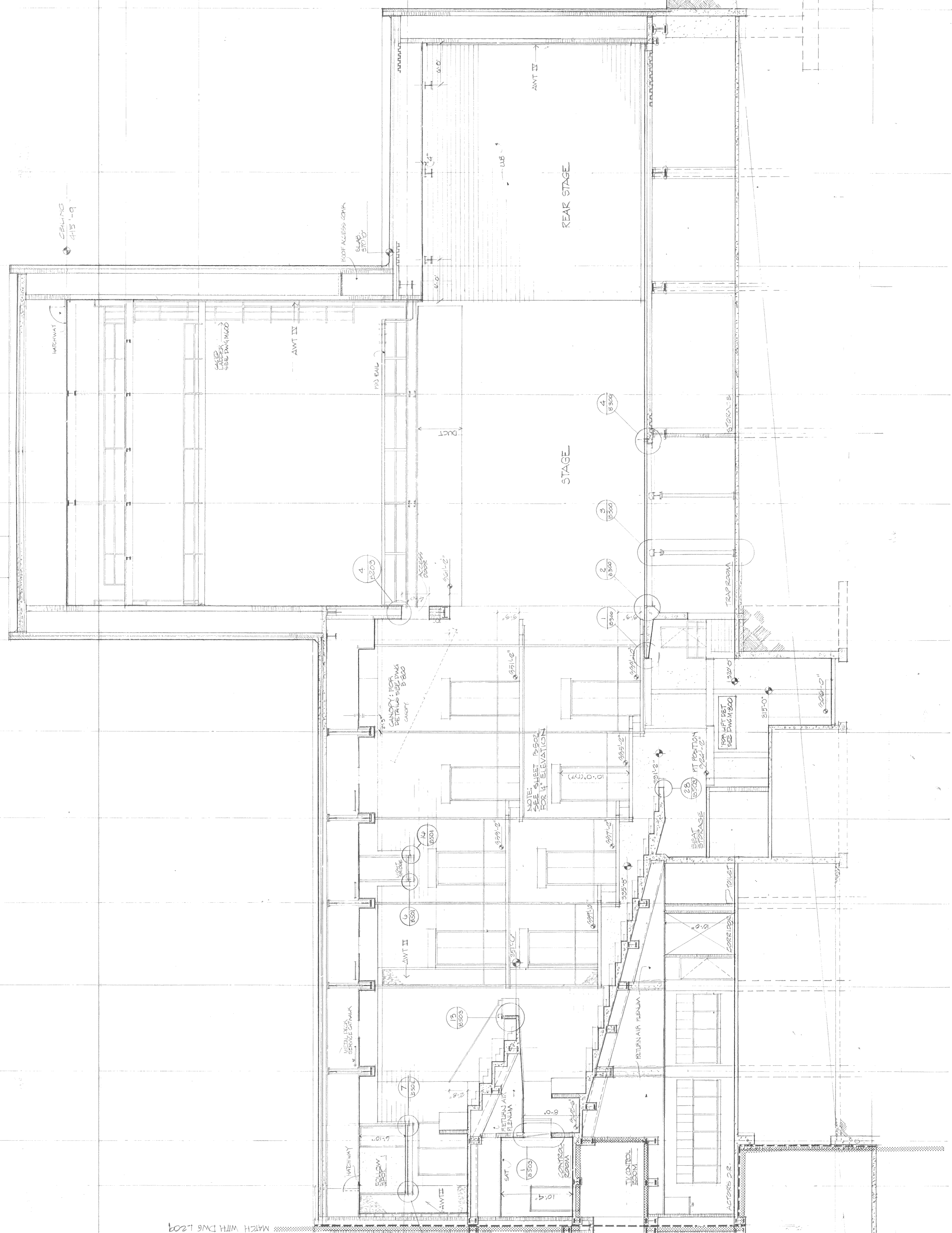

TOP OF CORNICE  
 EL. 391'-0"

CEILING  
 EL. 371'-0"

CEILING  
 EL. 358'-0"

BALCONY  
 EL. 358'-0"

TRUSS  
 EL. 345'-0"  
 CORNICE  
 EL. 344'-0"

TV CONTROL RM.  
 EL. 332'-0 1/8"  
 CORNICE  
 EL. 330'-0"

DR. BEAMS  
 EL. 325'-0"

CONCRETE  
 EL. 305'-0"

MISC.  
 EL. 300'-0"

MATCH WITH DWG L209

NOTE: FOR FOUNDATIONS SEE STRUCTURAL DWGS.



STATE UNIVERSITY OF NEW YORK COLLEGE AT  
 PURCHASE  
 STATE UNIVERSITY CONSTRUCTION FUND  
 PROJECT NUMBER 2520  
**PERFORMING ARTS CENTER**  
 EDWARD LARIBEE BURNES FAJA ARCHITECT  
 PETER G. ROLLAND ARCHITECT  
 WESLEY AND FOGWORTH CONSULTING ENGINEERS  
 SEGER AND DUTTON CONSULTING ENGINEERS  
 BOY, BEANER AND NEUMAN ARCHITECTS

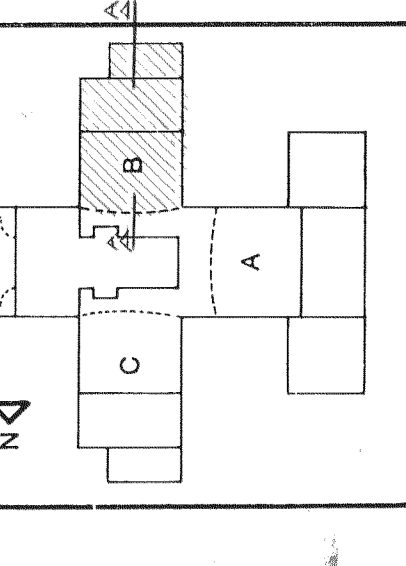

BUILDING SECTIONS  
**PAC B206**  
 SCALE 1/8" = 1'-0"  
 DATE 10 MAY 1972  
 DRAWN

SECTION A-A  
 TAKEN AT ④ LOOKING EAST

CONFORMED DWG.